

## 8. OTHERS

### 1. QUICK COUPLER

- ▲ Always check that the attachment is properly secured to the quick coupler by pressing the front part of the attachment against the ground.
- ▲ Never use an attachment before you have checked its mounting.
- ※ If you are uncertain if the attachment is securely locked, you must visually check that the lock pins of the quick coupler are in the lock position.

- (1) Operate the quick coupler switch on the monitor.
- (2) Switch to the quick coupler function screen and touch the 'Disengage Quick Coupler' button on the screen to release the quick coupler.



- ※ A warning pop-up message appears on the monitor screen, "Disengaging Quick Coupler" and the warning buzzer rings.
- ※ The buzzer warning rings until the quick coupler release and lock are complete.
- ※ During release, the red lamp of the quick coupler switch turns ON.



- (3) Loosen the coupling between the hook of the bucket and quick coupler through the bucket dump action.
- (4) Move the machine backward to separate the quick coupler and the bucket.



- (5) Tilt quick coupler forward and align the upper attaching points of the quick coupler with upper attaching points on the bucket.
- (6) Raise the boom until the bucket rests in the quick coupler and tilt the quick coupler rearward until the bucket is level.

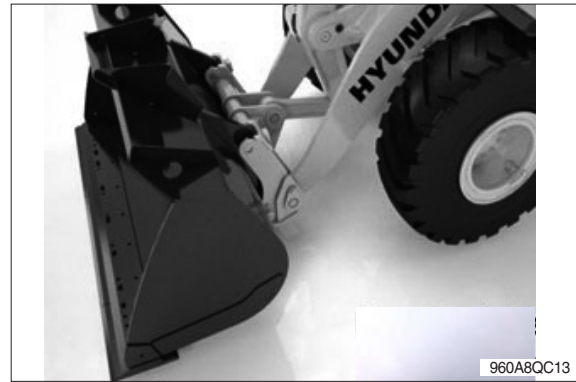

- (7) Touch the 'Engage Quick Coupler' button on the monitor screen to lock the quick coupler.

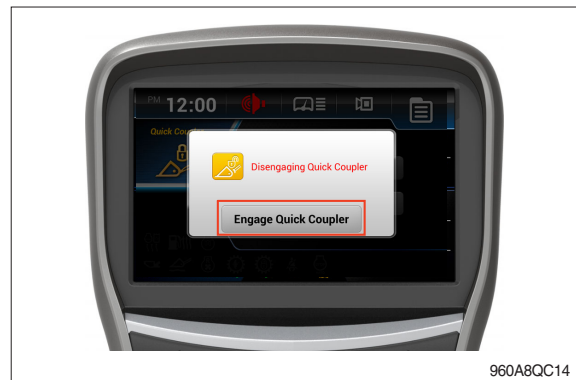

- ※ A warning pop-up message of "Engaging Quick Coupler" appears on the monitor screen and the warning buzzer rings.
- ※ During locking, the green lamp of the quick coupler switch turns ON.



- (8) Check whether the quick coupler is locked and touch the 'Complete' button on the monitor screen.

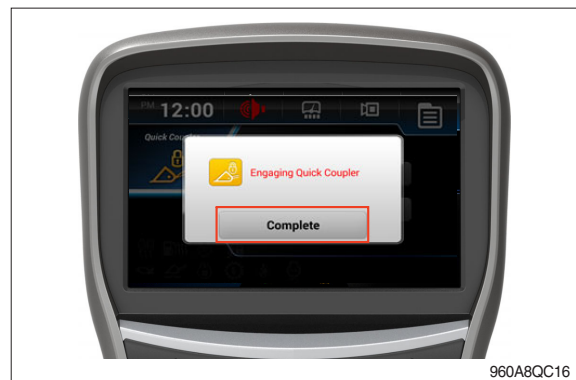

※ Check for engagement as followings.

- Put down pressure on the attachment.
- Back up the machine and make sure that there is no movement between the quick coupler and attachment.

※ Check that the indicator is lock position.

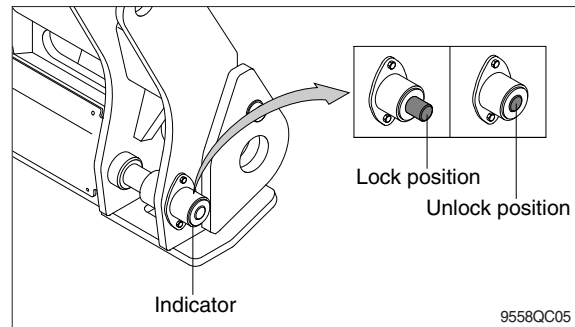

## (9) PRECAUTION OF USING QUICK COUPLER

- ⚠ When operating the machine with quick coupler, confirm that the quick coupler switch is lock position.

Operating the machine with quick coupler switch unlock position can cause the bucket to drop off and bring about the accident.

- ⚠ Serious injury or death can result from this accident.

